



Contents 目錄

- **Introduction 引言**
- **Engagement Events for Stage 2 第二階段持份者參與計劃**
- **Preliminary Summary of Views from Meetings & Workshops**
簡報從交流會及工作坊收集得的意見
 - Enhancement of College Life 校園生活添姿采
 - Venues for Academic & Recreational Activities 教研康體設施
 - Creating a Pedestrian-Friendly Campus 創建行人取向校園
 - Campus Landscape 校園景觀
 - A Sustainable Campus 可持續發展校園
 - Conservation of Places with Cultural Significance 文化景貌保育
- **Next Steps 下一階段**

Introduction 引言

Work Stages of CMP 校園發展計劃工作流程

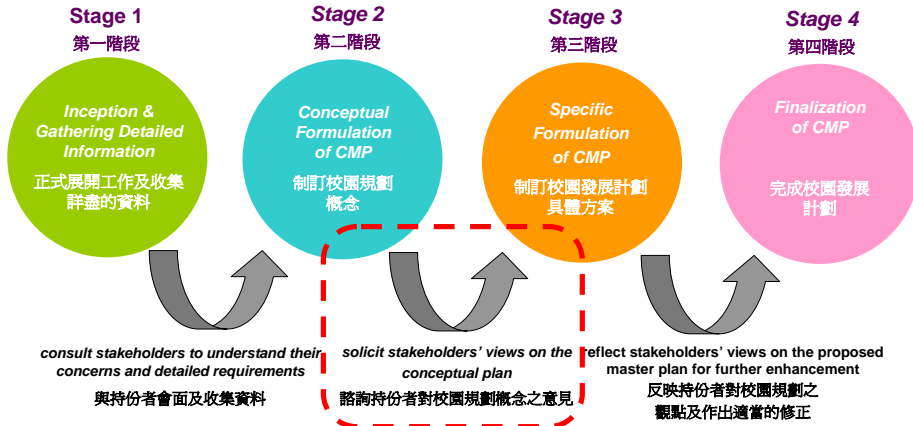

Engagement Events for Stage 2 第二階段持份者參與計劃

Solicit stakeholders' views on the conceptual plan
諮詢持份者對校園規劃概念之意見

Engagement Events 持份者參與活動

- Engagement Meetings 校園規劃交流會
- Engagement Workshops 校園規劃工作坊
- Engagement Forum 校園規劃論壇
- View Collection Form 意見收集表格



Engagement Events for Stage 2 第二階段持份者參與計劃

Solicit stakeholders' views on the conceptual plan 諮詢持份者對校園規劃概念之意見

Engagement Meetings 校園規劃交流會



Engagement Events for Stage 2 第二階段持份者參與計劃

Solicit stakeholders' views on the conceptual plan 諮詢持份者對校園規劃概念之意見

Engagement Workshops 校園規劃工作坊



Engagement Events for Stage 2 第二階段持份者參與計劃

| Event 活動 | Date 日期 | Attendance 出席人數 |
|--|------------------------------------|--------------------|
| Engagement Meetings 校園規劃交流會 | 2 October 2008 (2:30pm – 4:00pm) | 41 |
| | 2 October 2008 (7:00pm – 8:30pm) | 22 |
| | 3 October 2008 (10:00am – 11:30am) | 26 |
| | 3 October 2008 (7:00pm – 8:30pm) | 12 |
| Engagement Workshops 校園規劃工作坊 | 6 October 2008 | 18 |
| | 8 October 2008 | 28 |
| | 9 October 2008 | 14 |
| Total 總人次 | | 161 |

Preliminary Summary of Views from Meetings & Workshops 簡報從交流會及工作坊收集得的意見



Key Planning Issues 重點規劃課題

Enhancement of College Life
校園生活添姿采

Venues for Academic & Recreational Activities
教研康體設施

Creating a Pedestrian-Friendly Campus
創建行人取向校園

Campus Landscape
校園景觀

A Sustainable Campus
可持續發展校園

Conservation of Places with Cultural Significance
文化景貌保育



Enhancement of College Life 校園生活添姿采



General Feedback:

- Generally supported the idea regarding the linkage within colleges and among colleges. However, colleges should maintain their own identities.
- Participants in the engagement events agreed the idea of creating anchor points for student gathering and interaction with supporting facilities, such as café
- Participants generally accepted the idea of forming a neighborhood setting for the new and existing colleges. However, further study is needed for facilities sharing.
- It was suggested that the consultant should also take into account the university life of non-residence students.

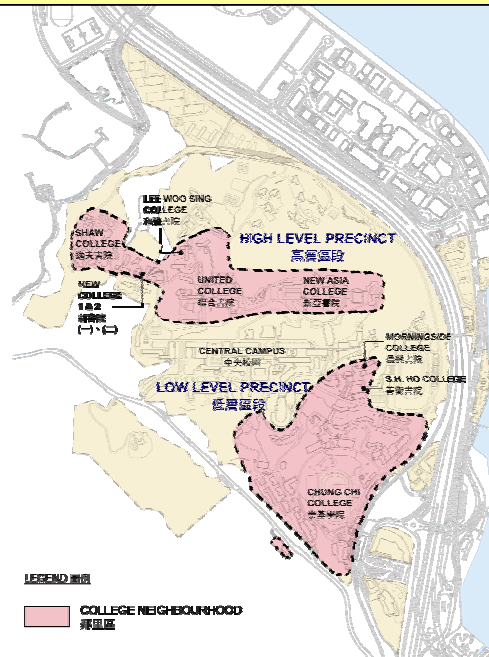

Chung Chi College 崇基學院

- General consensus was found on agreeing the enhancement of the central focus such as improving the water quality in Weiyuan Lake and Lingnan Stadium.
- Diverse views were received regarding the idea of cascading landscape between central focus to University Avenue. Some participants agreed the idea while others commented that the provision of new plaza / courtyards might affect the privacy of the college.

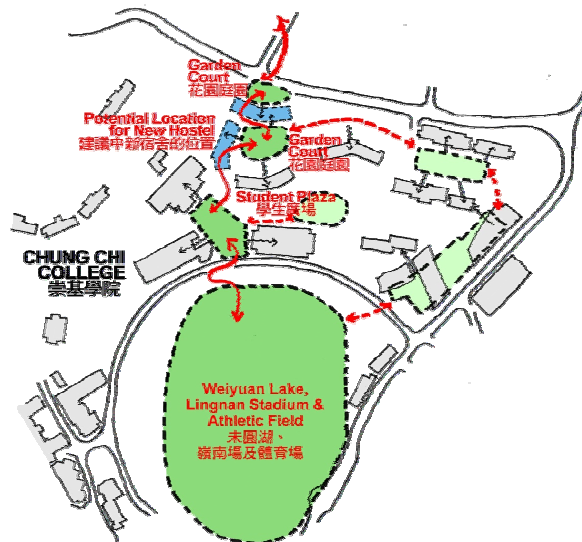

New Asia College 新亞書院

- Diverse views were received in the enhancement of central courtyard in front of the Statue of Confucius. Some supported the idea to provide a central gathering space, while others preferred to maintain the existing setting.
- Participants generally accepted the proposed location for new hostel.

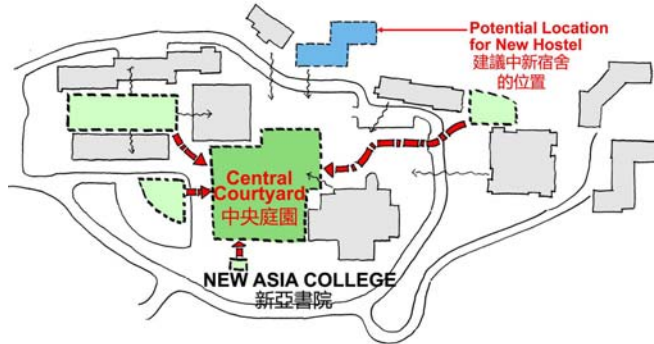

United College 聯合書院

- Participants generally accepted the idea to maintain the lawn areas.
- Diverse views were received regarding the location of the new hostel. Some commented the proposed site might not be the preferred location.
- Some participants suggested to review the loading of the lift in Chen Chun Ha Hostel as 3 more new colleges would be established in the high-level precinct.

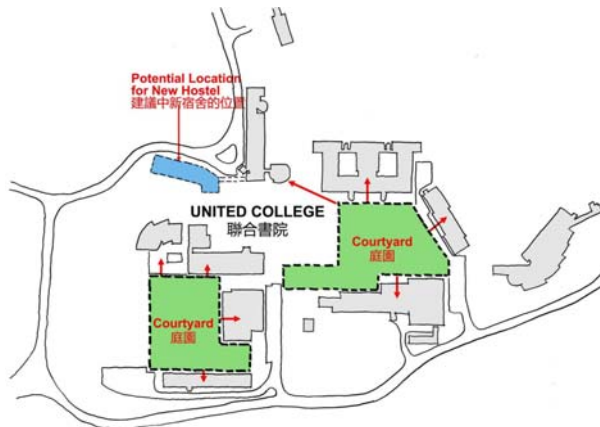

Shaw College 逸夫書院

- Participants generally supported the idea of transforming the roundabout and parking bays into pedestrian zone to form an open plaza.
- Some suggested to reconfigure the area in front of Shaw Terrace to allow the shuttle bus to turn around.
- participants generally support the idea of transforming Ya Qun Lodge into an amenity building or other purposes.

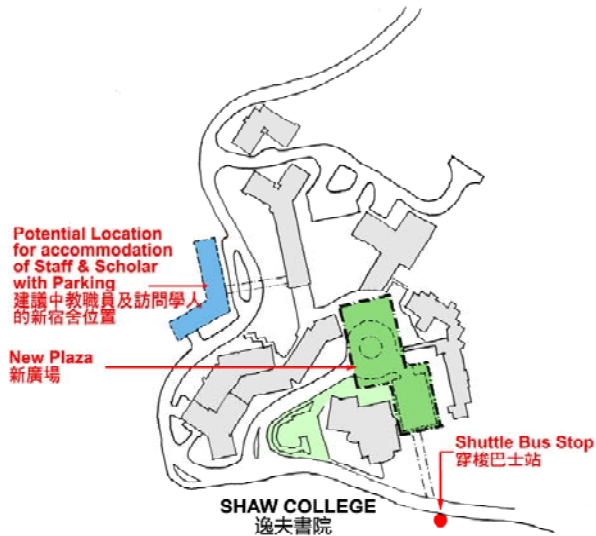

New Colleges 新書院

- Generally agreed on the enhancement of connection to the Central Campus and to existing colleges.
- Some opined that connection through college neighborhood might reduce the privacy of college due to the increase of pedestrian movement.
- It was agreed that the harmony between the new colleges and the surrounding landscape was essential.
- Some participants suggested to provide sufficient open areas at the new colleges for student activities.
- Some participants showed concern if there is any potential space for future expansion of the new colleges.

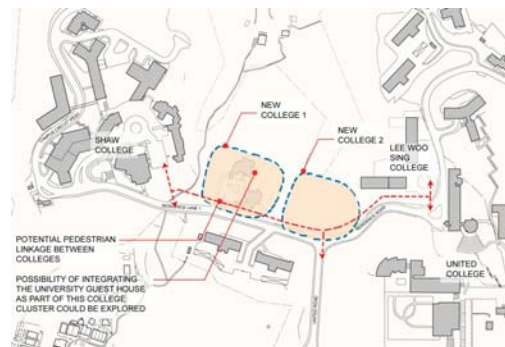

Venues for Academic & Recreational Activities 教研康體設施



Key Planning Issues 重點規劃課題

Venues for Academic & Recreational Activities 教研康體設施

General Feedback:

- Generally consensus was found in maintaining the Central Campus as the major teaching and administration centre.
- Some participants opined that it was not necessary to concentrate most of the teaching facilities in Central Campus. They could be distributed in different parts of the Campus to avoid overcrowding in Central Campus.
- Regarding the location of research facilities, participants generally agreed locating them relatively further away from the Central Campus. However, sufficient transportation and supportive facilities must be provided.
- Most participants accepted the formation of communities of academic disciplines to achieve physical proximity and obtain the benefits of interdisciplinary collaboration.

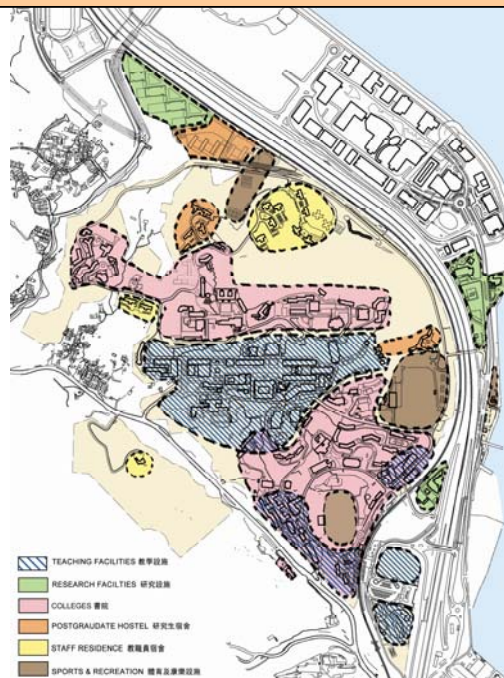

Key Planning Issues
重點規劃課題

Venues for Academic & Recreational Activities
教研康體設施

Regarding the importance of the potential developments:

Site A - Area 39 39區

Participants generally agreed developing Area 39 into a research hub if sufficient transportation and amenity facilities are provided.

Site B - Vacant Site next to University Station 大學站旁的土地

Participants generally accepted the idea of developing the site with possible academic, continuing education and community facilities. Concerns are raised regarding the connection to Central Campus

Site C - Open Car park outside John Fulton Centre 富爾敦樓旁停車場

Most participants supported the site used for administrative and amenity facilities development with sufficient carparking provision.



Key Planning Issues
重點規劃課題

Venues for Academic & Recreational Activities
教研康體設施

Regarding the importance of the potential developments:

Site D - Academic Building 1 教研樓一座

Neutral views were received from participants about the redevelopment of the site for academic facilities. Tree preservation at the site shall also be taken into consideration.

Site E - Village Path 山村徑

The idea of developing the area for academic facilities was generally accepted. Most people agreed on the use of cascading terraces to follow the natural slope of the hill down to a new plaza at Clinic Road. Some concerned that there would be less staff accommodation in the Central Campus

Site F - Romney Stores (Nissan Huts) 貯物庫

Generally supported the idea to develop an indoor sports complex at Site F. New sport facilities should be considered near the new colleges.



Creating a Pedestrian-Friendly Campus 創建行人取向校園

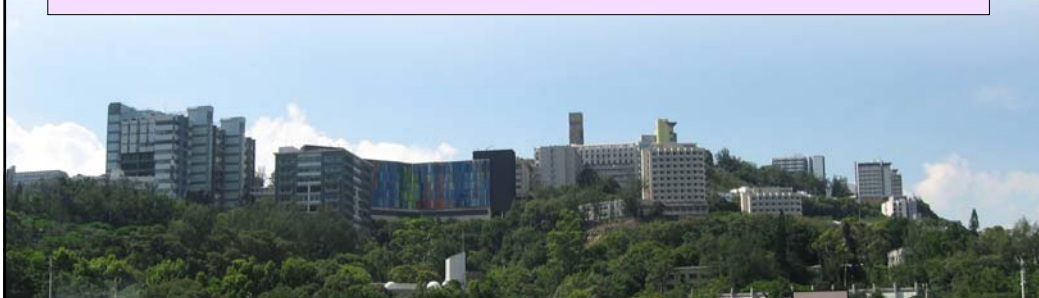

Key Planning Issues 重點規劃課題

Creating a Pedestrian-Friendly Campus 創建行人取向校園

General Feedback:

- General consensus was found to accept the provision of additional vertical links in the campus.
- Some suggested those vertical links should be provided at the periphery of the colleges.
- Participants strongly supported the idea of exploring new exit at northern edge of platform of University Station.

The new exit would provide convenient access to Central Campus through the new Integrated Teaching Buildings.
- Neutral views were showed on promoting cycling in the campus. Some suggested that a designated cycle link should be provided to minimize conflicts with vehicular traffic.

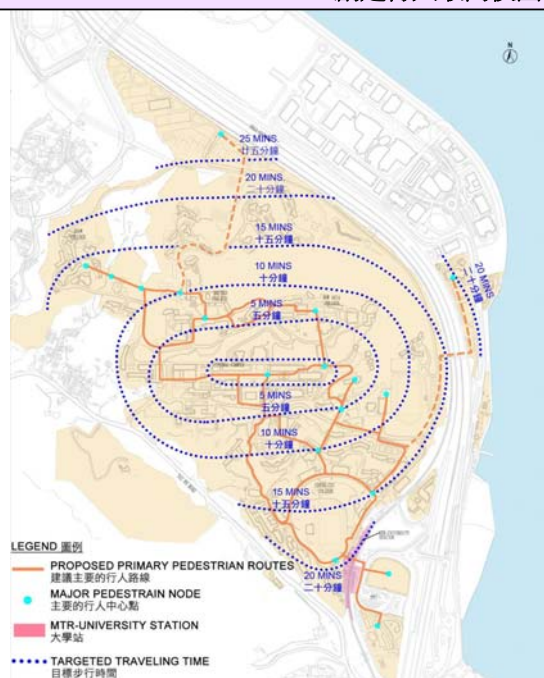

Key Planning Issues
重點規劃課題

Creating a Pedestrian-Friendly Campus
創建行人取向校園

- Participants agreed the idea of centralizing car parking areas for visitors. However, sufficient shuttle bus services and pedestrian links should be provided near the car parking to divert visitors.
- Participants generally welcomed the idea of improving the bus route & schedule; and introducing environmentally friendly buses.
- Concern was raised on the increasing of population after 3-3-4 and beyond. Enhancement to the roads, pavements, pedestrian links might need to cater the increase of pedestrian movement.

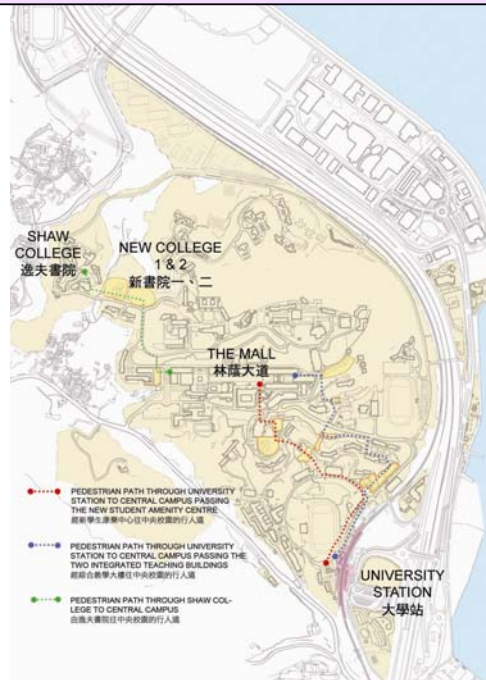

Campus Landscape
校園景觀



General Feedback:

- Generally accepted the idea to achieve a network of landscaped open areas for social gathering linking with major pedestrian routes.
However, network should extend to semi-open spaces and even indoor areas (e.g. Learning commons).
- Participants supported the promotion of natural trails.
Some supplemented that there should be a variety of pedestrian links for different type of users.
The proposed natural trails should not be too extensive and artificial to damage the natural scenery.
- It was generally agreed that thematic planting was less important.
The campus has many natural species of plants and animals. Bio-diversity should be maintained.



- **The Mall**
Most participants thought that the spatial design of the Mall should be maintained for large events such as the graduation ceremony.
Some suggested that enhancement to seating area could be considered.
- **Existing courtyard at Lady Shaw Building**
Some raised that it was less important to enhance the courtyard as relatively few university members visit this place.
- **University entrance at MTR Station**
Diverse views were received regarding enhancement to the area.
Some agreed to provide more seats with shade for gathering. However, some thought that the existing design should be retained.
Most participants suggested to establish landmarks representing the university's image at University Station plaza.



A Sustainable Campus 可持續發展校園



Key Planning Issues 重點規劃課題

A Sustainable Campus 可持續發展校園

Participants generally agreed on the following proposals:

- To establish guidelines to reduce the environmental impact of any new structures to the existing campus.
- To promote greening and environmentally friendly building design.
- To establish additional policy on the reduction of greenhouse gas emissions and energy consumption.

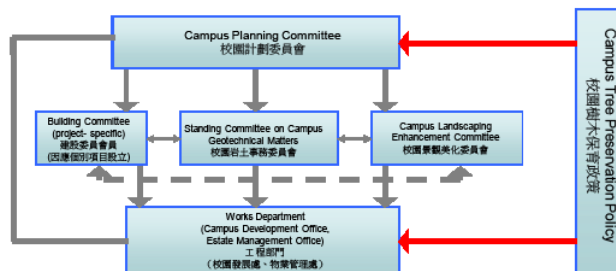

Conservation of Places with Cultural Significance 文化景貌保育



Key Planning Issues 重點規劃課題

Conservation of Places with Cultural Significance 文化景貌保育

Participants generally supported the idea of imposing an assessment procedure for the interventions to “places with cultural significance”

The followings are some issues noted from the participants:

- Consider to establish a committee to implement the policy
- Queries on enforcement of the policy
- Queries on how to carry out the detailed assessment

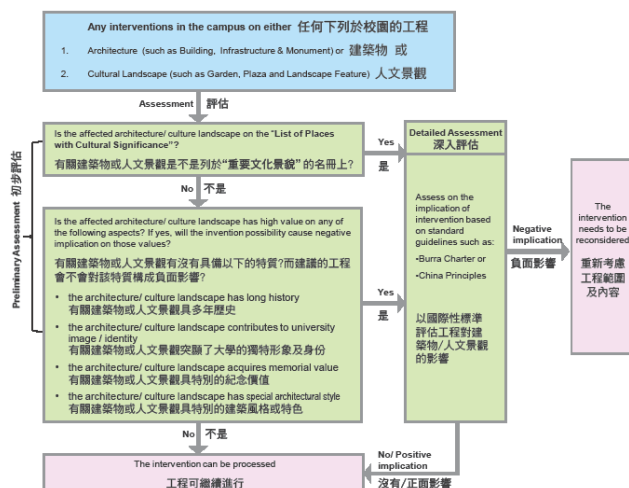

Next Steps 下一階段

We look forward to hearing your views and suggestions at the **Stage 2 Engagement Events**, which will be valuable to us for the formulation of the **Stage 3 Specific Campus Master Plan**



Stage 2 Engagement Events 第二階段持份者參與計劃

- **Engagement Meetings: 2 & 3 October 2008**
(Focus discussion on specific topics & issues)
- **Engagement Workshop: 6, 8 & 9 October 2008**
(Interactive discussion among stakeholders and consultants on the 6 Key Planning Issues)
- **Engagement Forum: 11 October 2008**
(Summary of views collected in Engagement Meetings & Workshops)
- **View Collection Form: 1-31 October 2008**

Stage 3 - Specific Formulation of CMP

第三階段 - 制訂校園發展計劃的具體方案

Stage 4 - Finalization of CMP

第四階段 - 完成校園發展計劃

- To be conducted after receiving the feedback from Stage 2 Engagement Events
- To refine Conceptual Plan and develop specific plan in Stage 3
- To reflect stakeholder's view and develop the final plan

~ The End ~

