

Six Precepts
六項規劃原則

- 1 Conserving the Places of Value
文化景貌保育
- 2 Places for Academic & Recreational Activities
教研康體設施
- 3 Enhancing College Life
校園生活添姿采
- 4 A Landscape of Vital Importance
校園景觀
- 5 Creating a Pedestrian-Friendly Campus
創建樂步健行校園
- 6 Making a Sustainable Campus
可持續發展校園

STAGE 3 | Campus Master Plan | The Chinese University of Hong Kong | Aedas EDWARD CULLINAN ARCHITECTS MVA HONG KONG LTD. 3



Site A: Romney Stores (Nissan Huts) – Indoor Sports Complex
 貯物庫-室內運動綜合大樓

Notional Site Area: 5,290 m²
 Proposed Max GFA: 3,860 m²
 Proposed NOFA: 2,125 m²
 Plot Ratio: 0.4

Jockey Club Postgraduate Hall

New Sports facility

Sir Philip Hadden Cave Sport Field

STAGE 3 | Campus Master Plan | The Chinese University of Hong Kong | Aedas EDWARD CULLINAN ARCHITECTS MVA HONG KONG LTD.

Site A: Romney Stores (Nissan Huts) – Indoor Sports Complex
 貯物庫-室內運動綜合大樓

View from Sir Philip Hadden Cave Sport Field

STAGE 3 | Campus Master Plan | The Chinese University of Hong Kong | Aedas EDWARD CULLINAN ARCHITECTS MVA HONG KONG LTD.

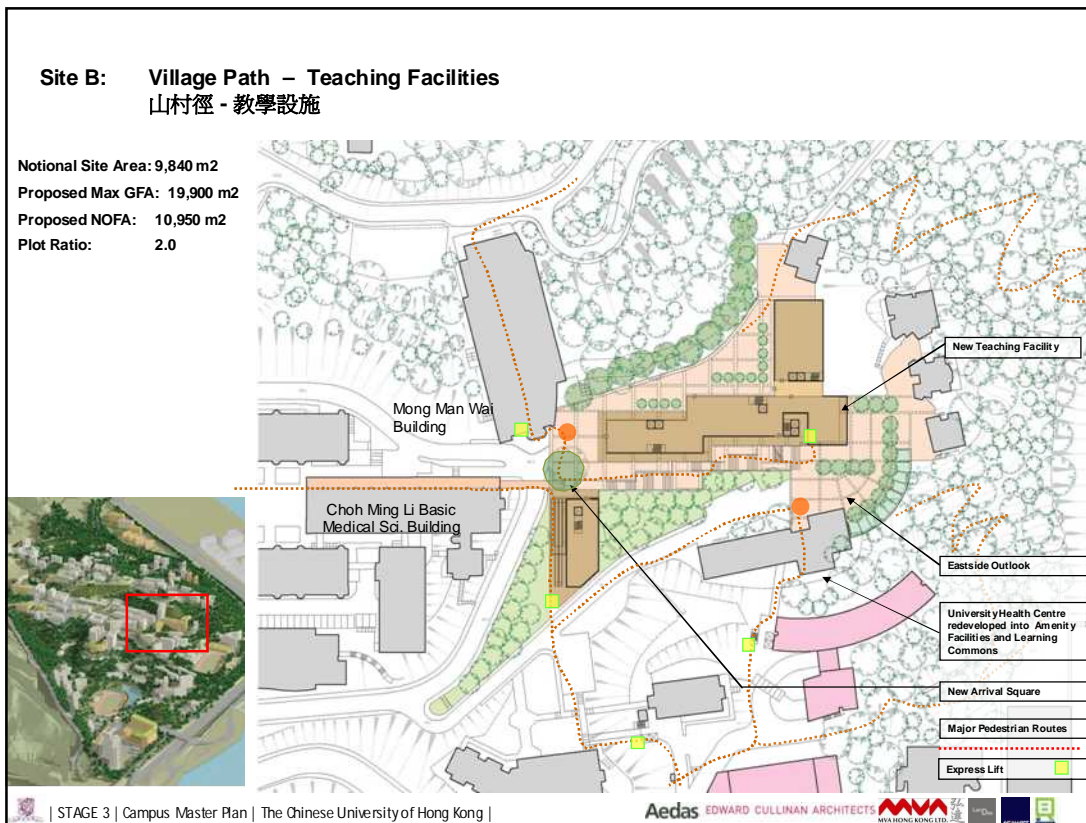

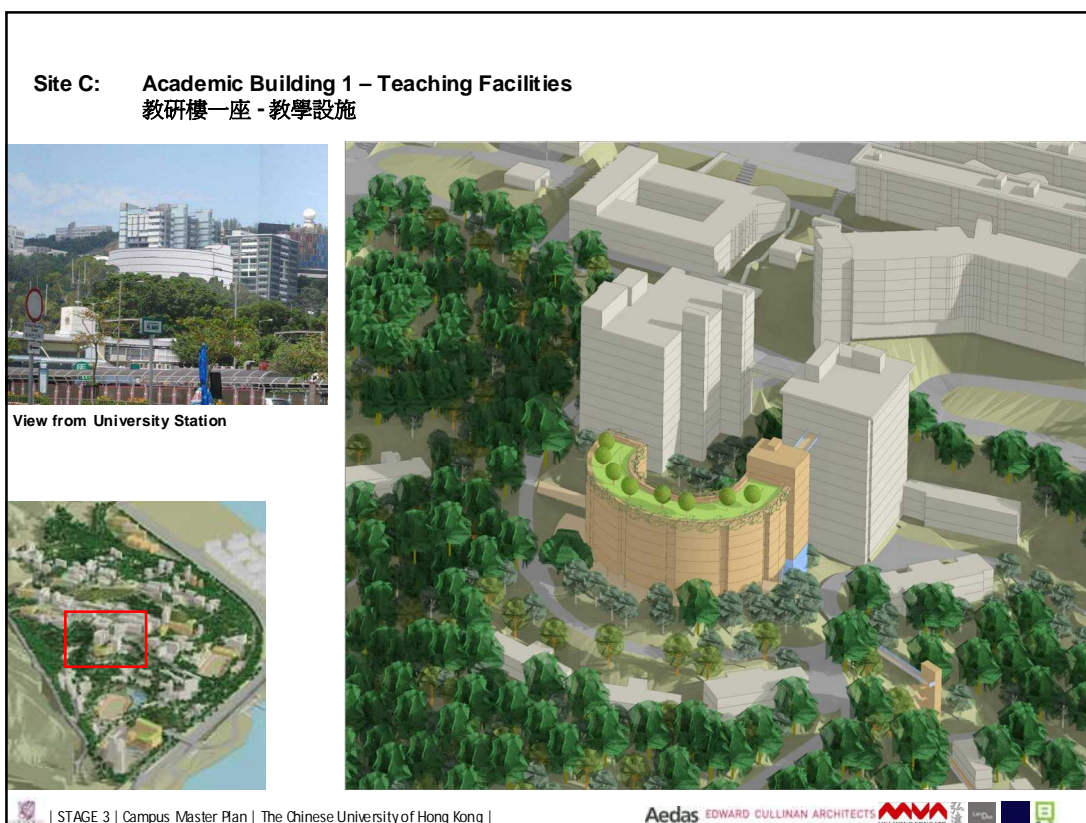
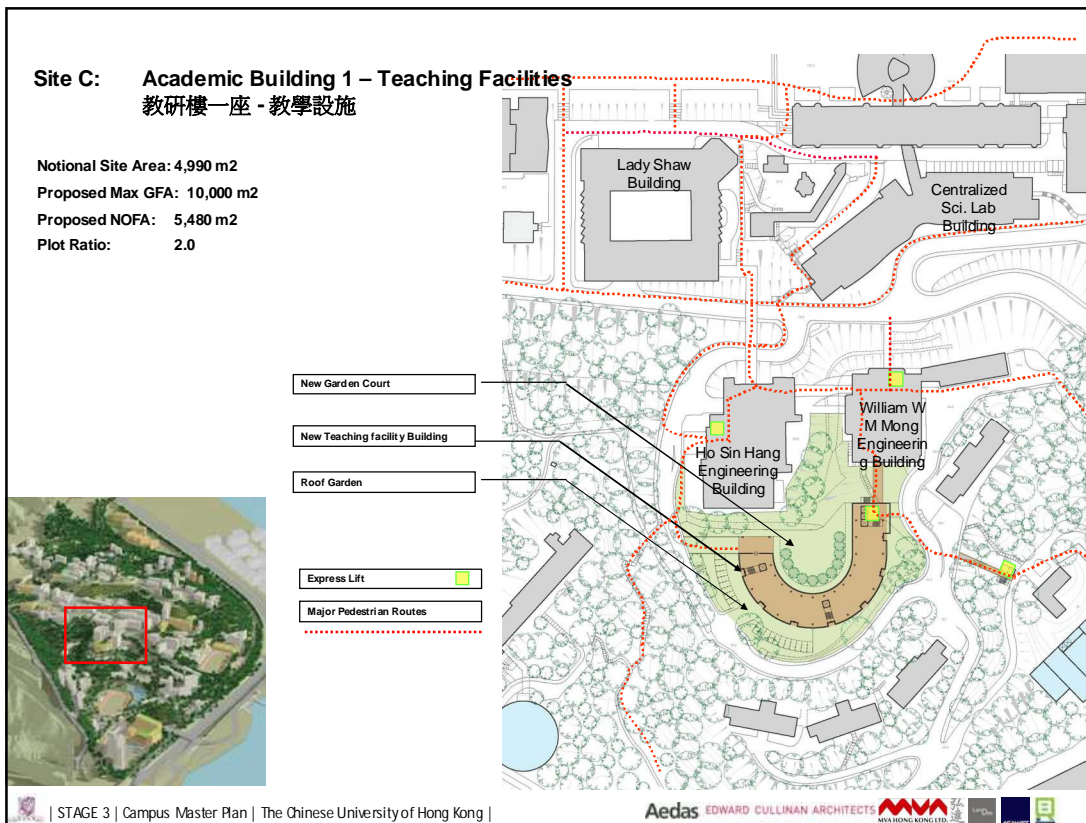

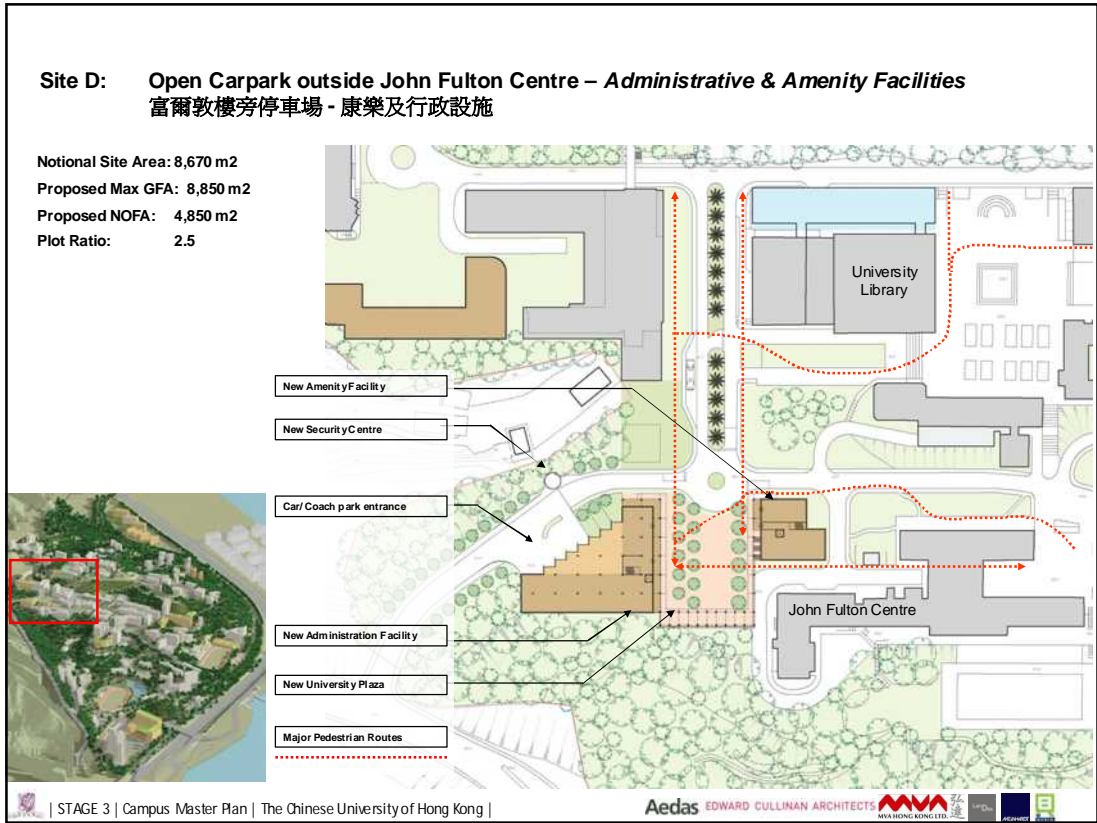

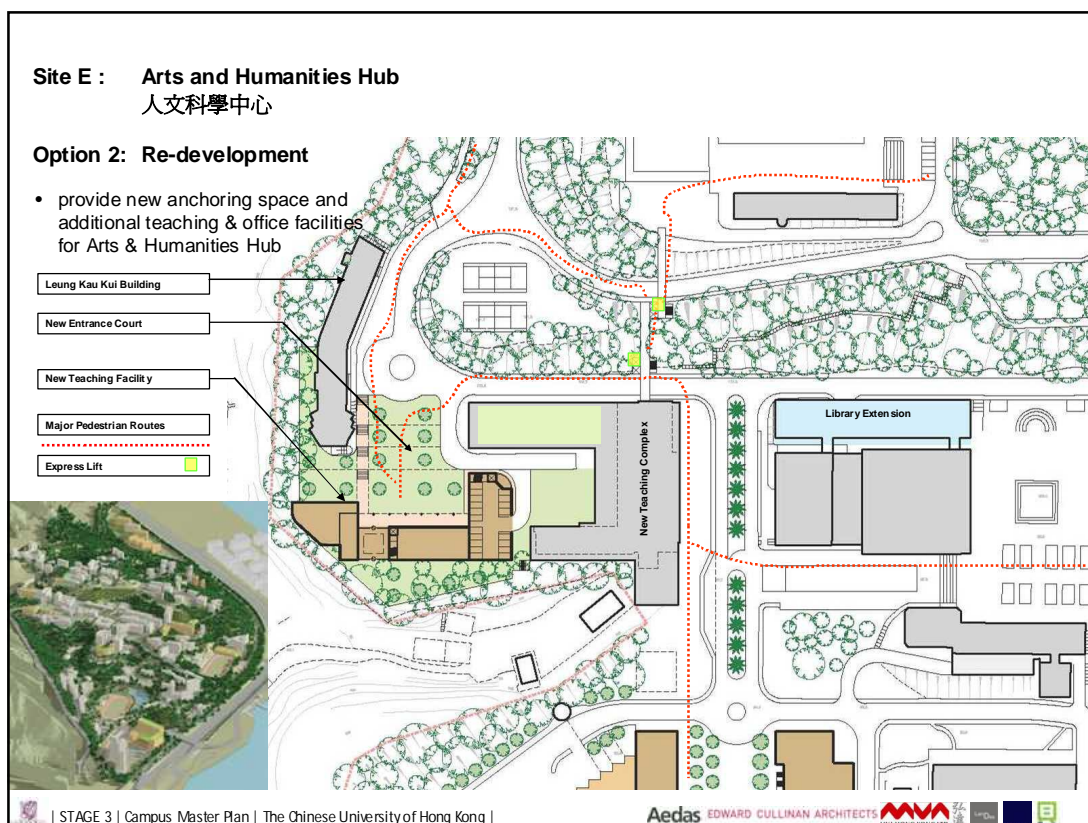
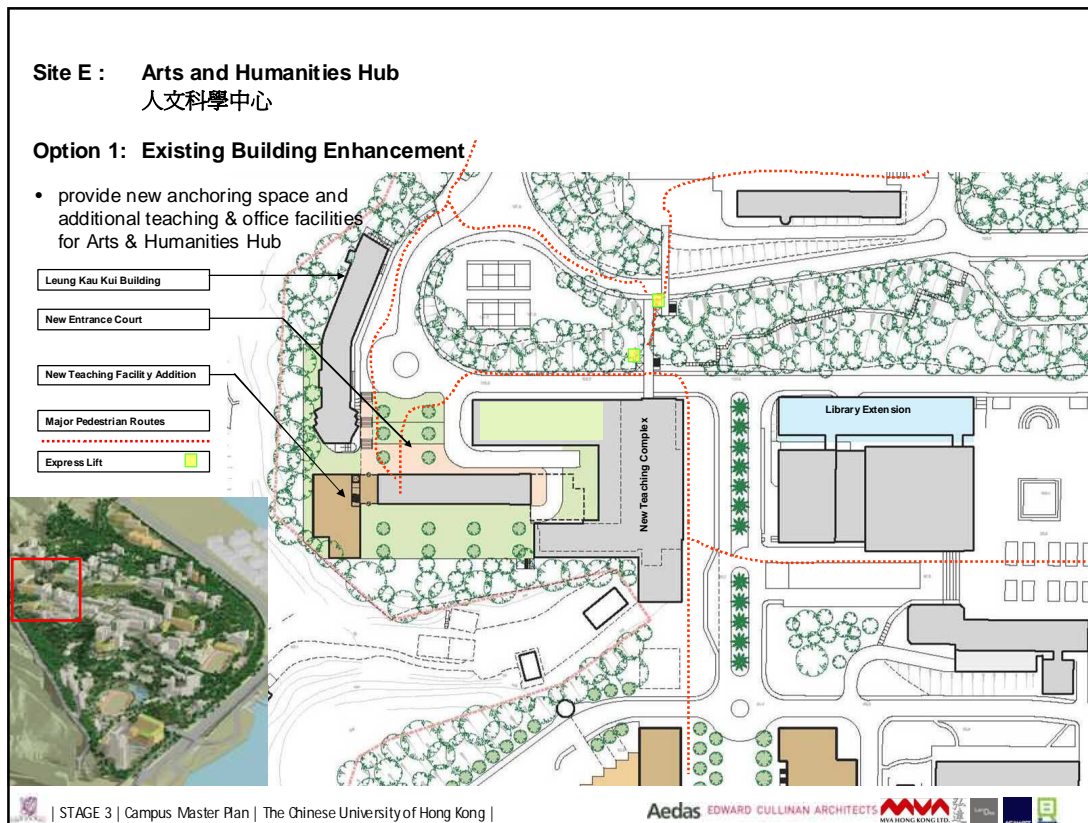

Site E : Arts and Humanities Hub
 人文科學中心

Option 2: Re-development

View of new Arts & Humanities Hub looking east



STAGE 3 | Campus Master Plan | The Chinese University of Hong Kong | Aedas EDWARD CULLINAN ARCHITECTS MVA HONG KONG LTD.

Site F: Staff Residences
 教職員宿舍

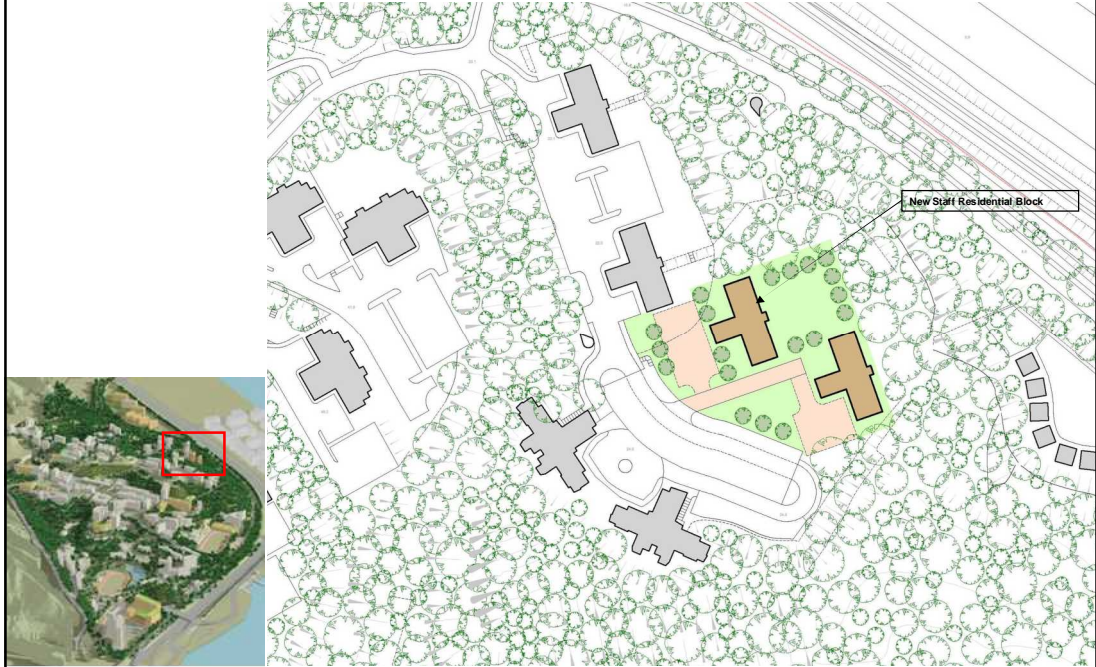

New Staff Residential Block

STAGE 3 | Campus Master Plan | The Chinese University of Hong Kong | Aedas EDWARD CULLINAN ARCHITECTS MVA HONG KONG LTD.

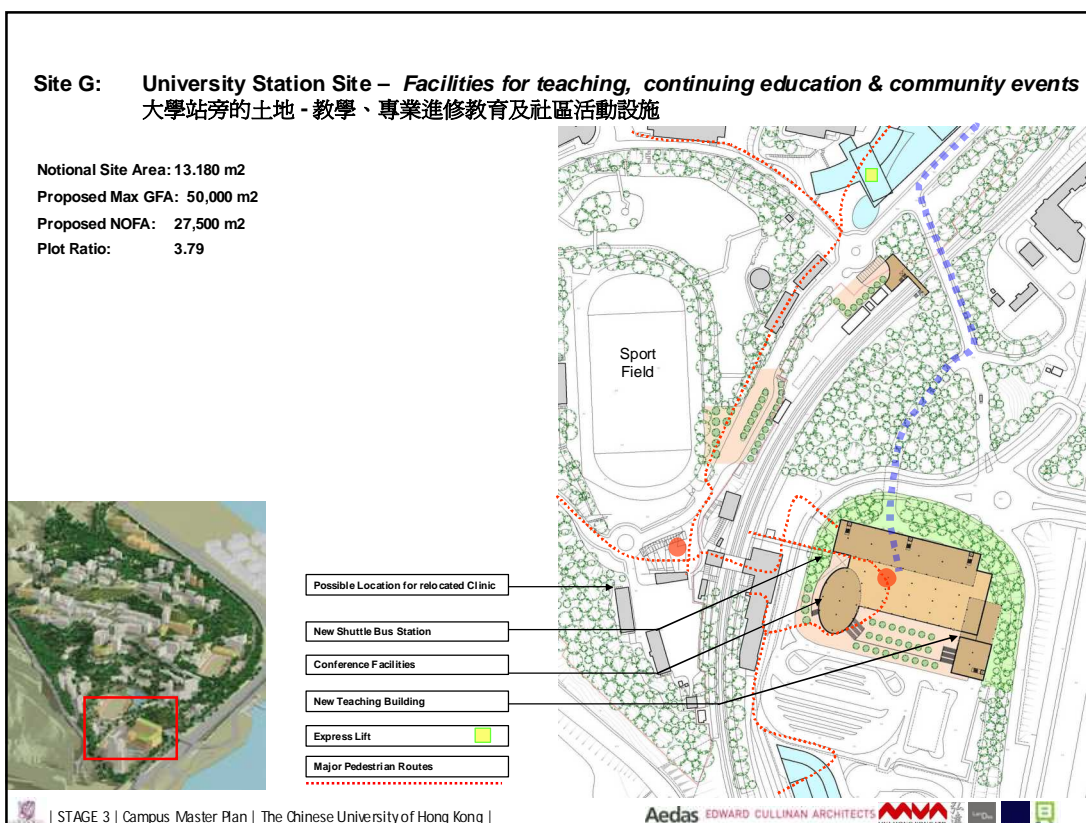
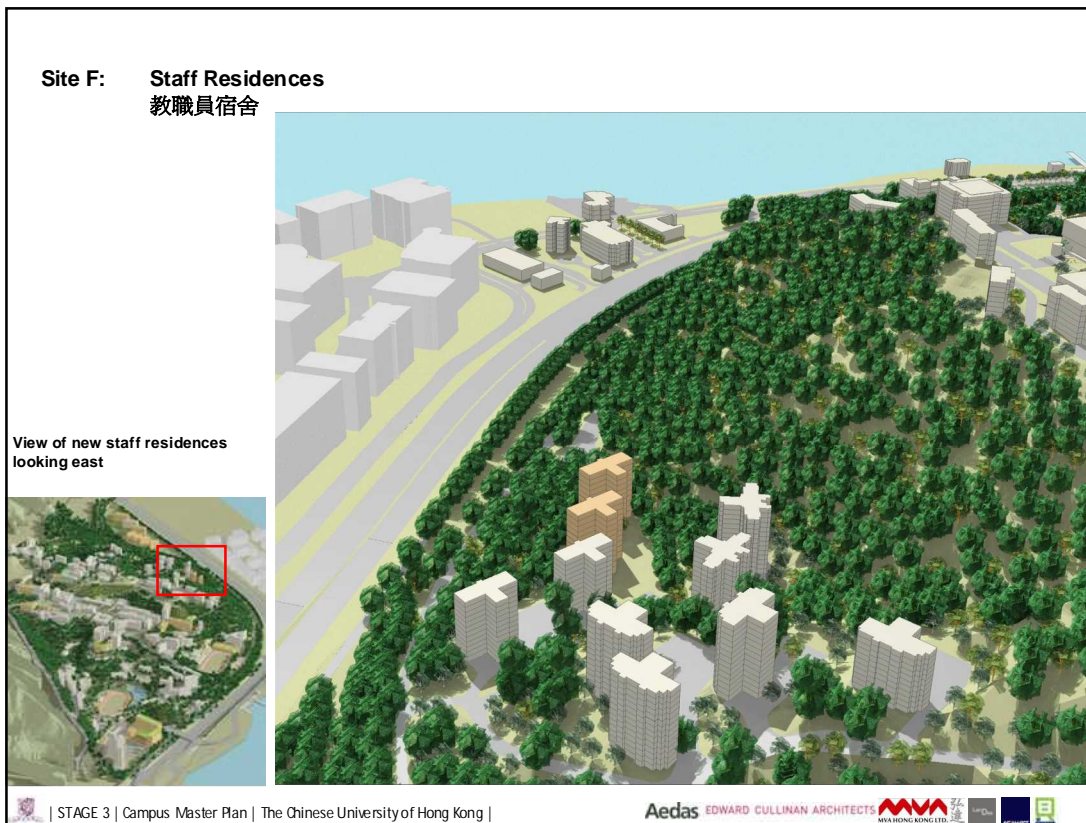

Site G: University Station Site – Facilities for teaching, continuing education & community events
 大學站旁的土地 - 教學、專業進修教育及社區活動設施

View from Tolo Harbour

STAGE 3 | Campus Master Plan | The Chinese University of Hong Kong | Aedas EDWARD CULLINAN ARCHITECTS MVA HONG KONG LTD.

Site H: Area 39 - Research Lab & Student Hostels (under Land Application)
 39區 - 研究綜合大樓及學生宿舍

Research Facilities:
 Notional Site Area: 3.57Ha
 Proposed Max GFA: 89,250 m2
 Proposed NOFA: 61,360
 Plot Ratio: 2.5

Student Hostels:
 300 students per block

Centralised General Research Lab Complex Block 3
 Centralised General Research Lab Complex Block 1
 Centralised General Research Lab Complex Block 2
 Student Hostel Development
 Amenity Podium
 Hostel Blocks

Pedestrian Link & Natural Trail to Area 39

STAGE 3 | Campus Master Plan | The Chinese University of Hong Kong | Aedas EDWARD CULLINAN ARCHITECTS MVA HONG KONG LTD.

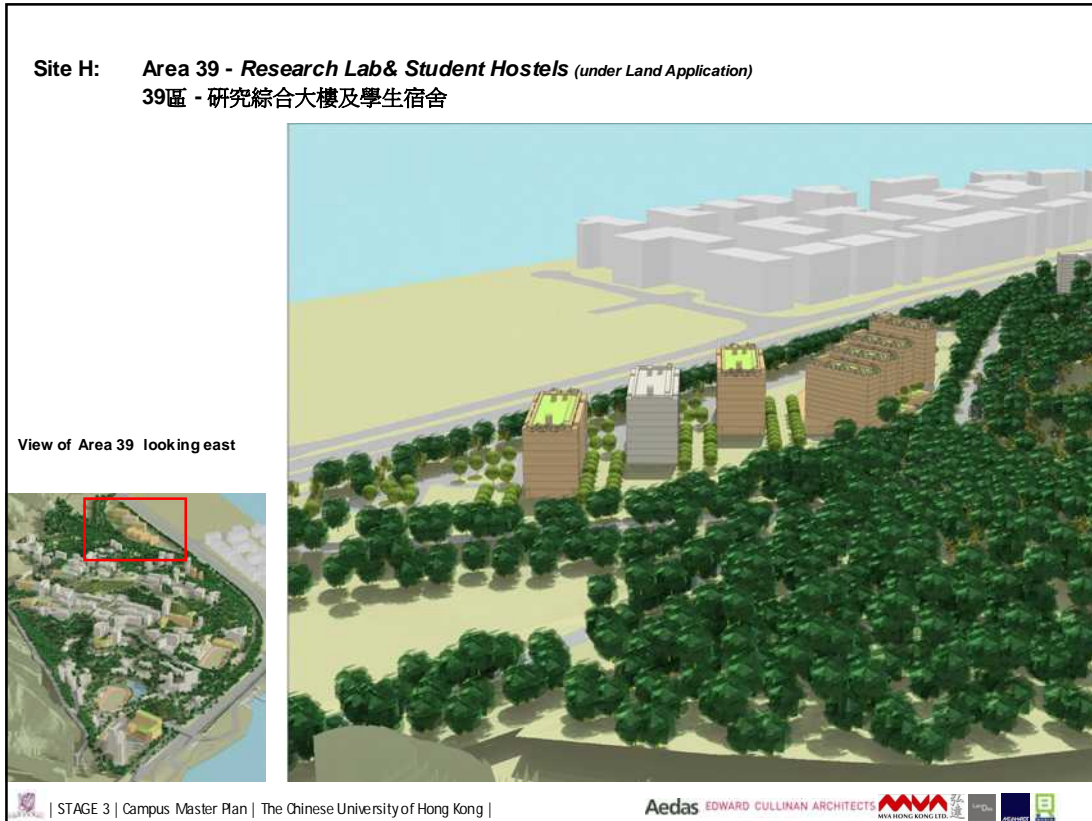



Shaw College 逸夫書院

Potential Location for new
 Hostel and New college Plaza



College Neighbourhood 鄰里區

- 5 new colleges have been established to cater for the increase intake of undergraduate students
- Two Neighbourhood Zones are proposed:
 - 1 Low-level Precinct - Morningside College and S. H. Ho College form a college neighbourhood with the existing Chung Chi College
 - 2 High-level Precinct - Lee Woo Sing College and two new colleges form a college neighbourhood with the existing New Asia College, United College and Shaw College

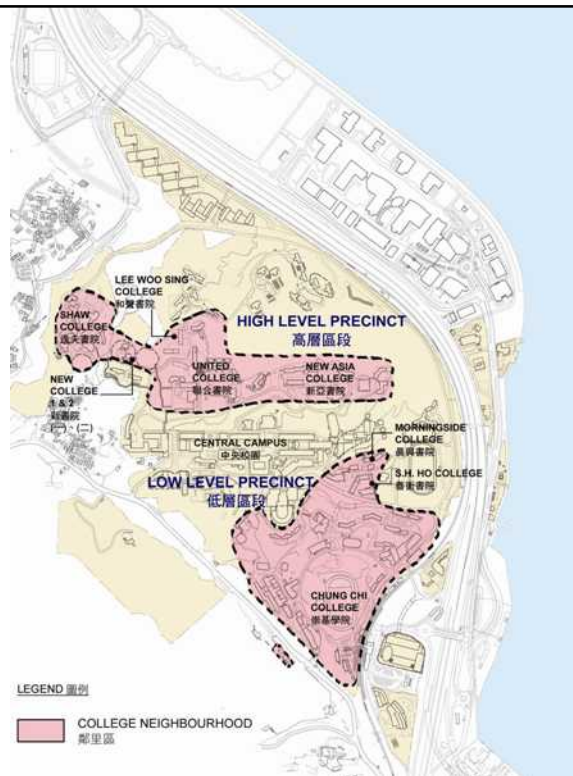

LEGEND 圖例

COLLEGE NEIGHBOURHOOD 鄰里區

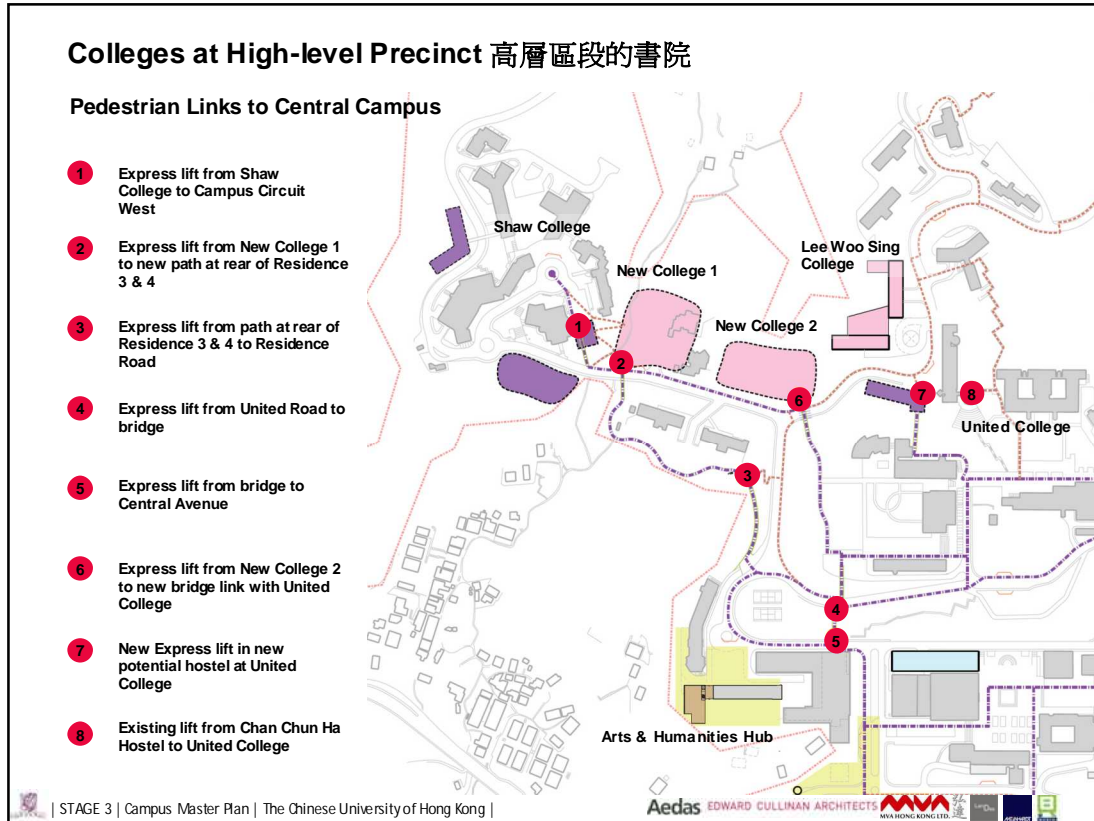

Learning Commons 學習開放空間

Shifting Paradigms in Universities

Old Paradigm	New Paradigm
Knowledge is presented objectively to students	Knowledge is (co)-constructed by individuals and groups
Education process - timetabled by institution & controlled by a teacher	Learning occurs at a time and a place convenient to the learner
Students dependent on institution to guide them through their study	Students independent and have greater choice what they study
Education process - timetabled by institution & controlled by a teacher	Learning occurs at a time and a place convenient to the learner

Semi-outdoor learning space at Singapore Management University

STAGE 3 | Campus Master Plan | The Chinese University of Hong Kong | Aedas EDWARD CULLINAN ARCHITECTS MVA HONG KONG LTD.

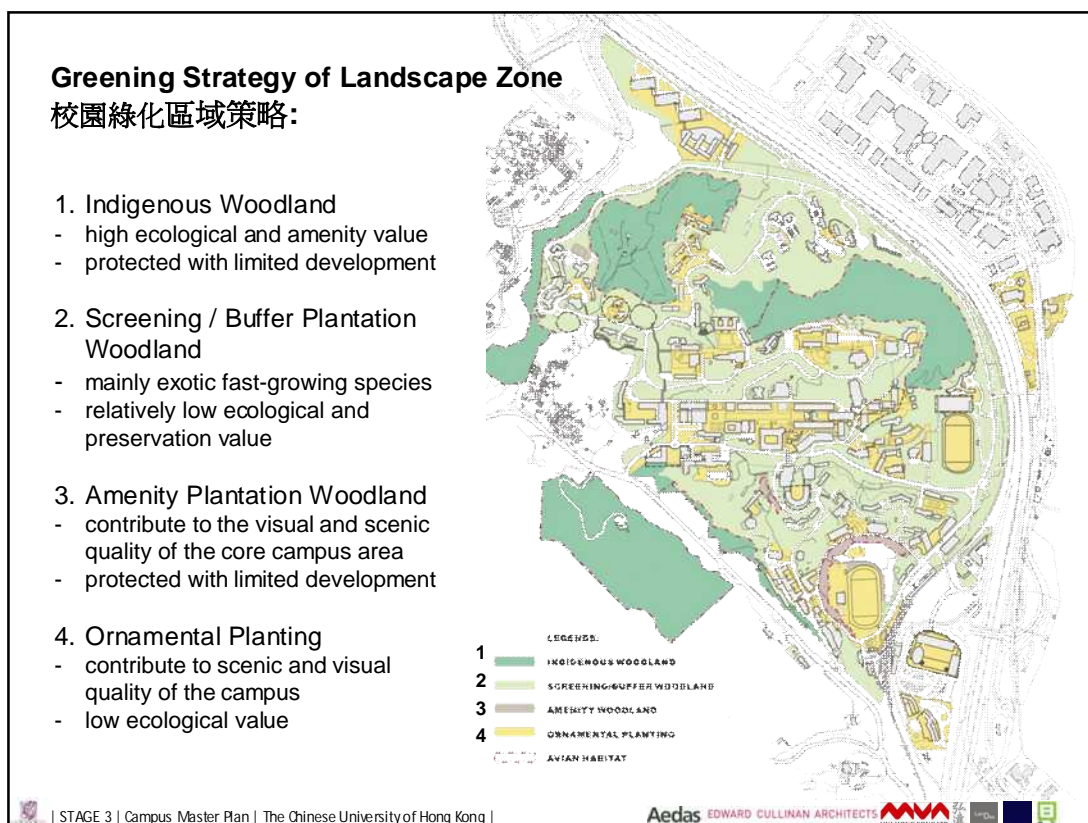
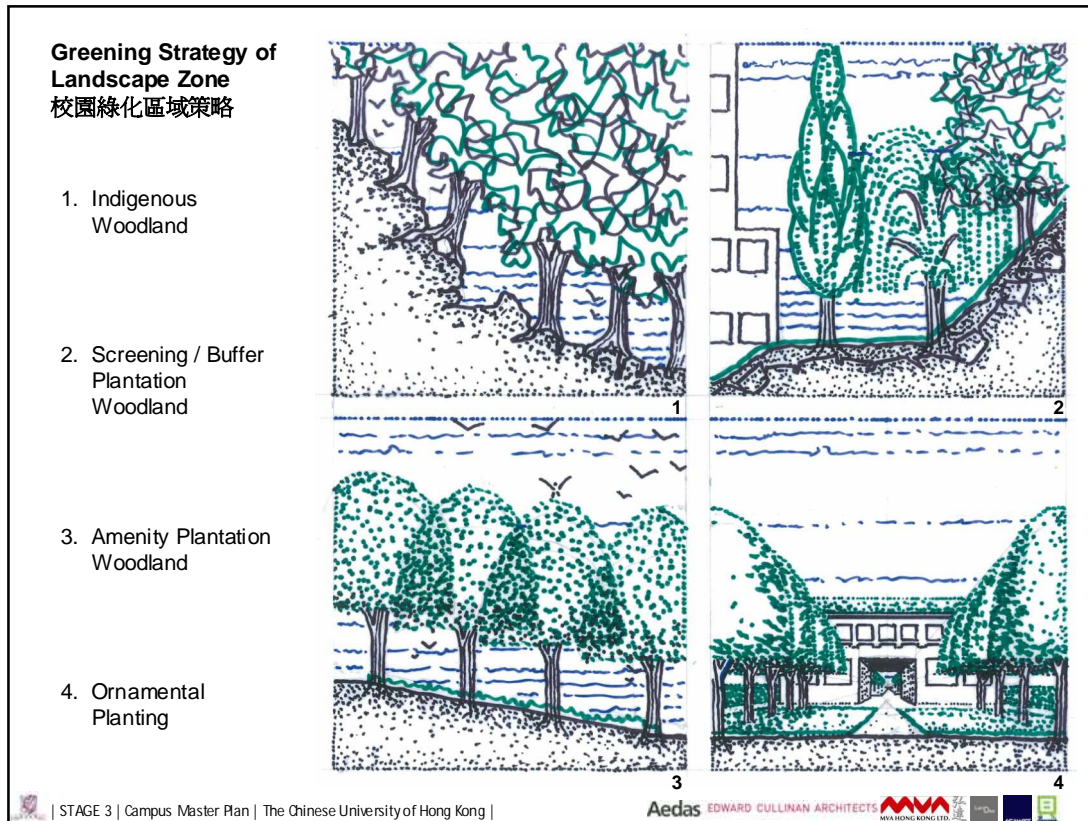

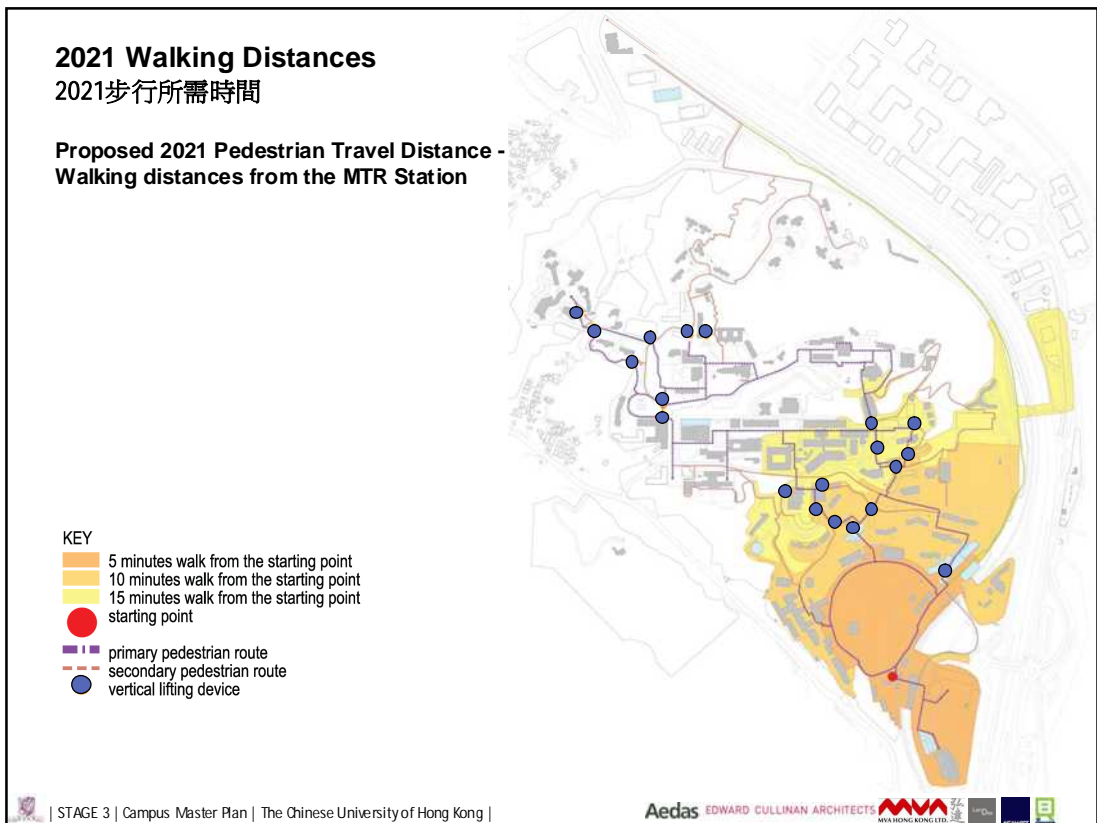
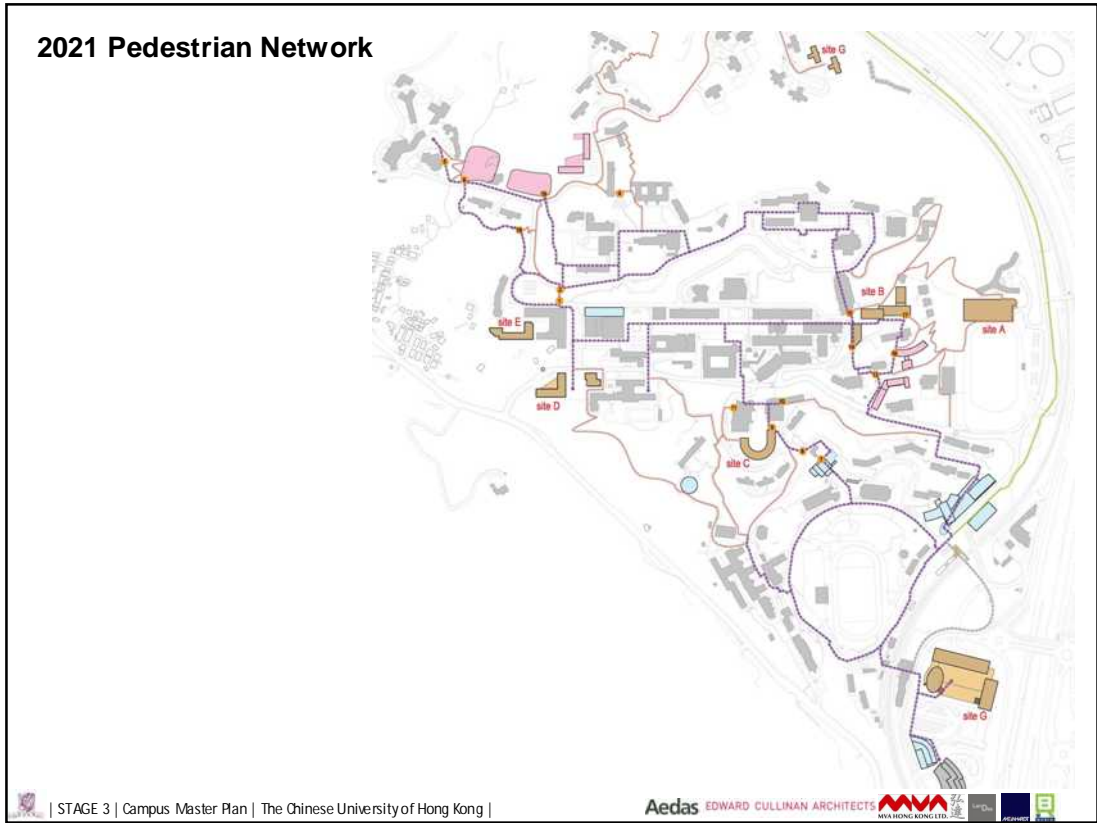

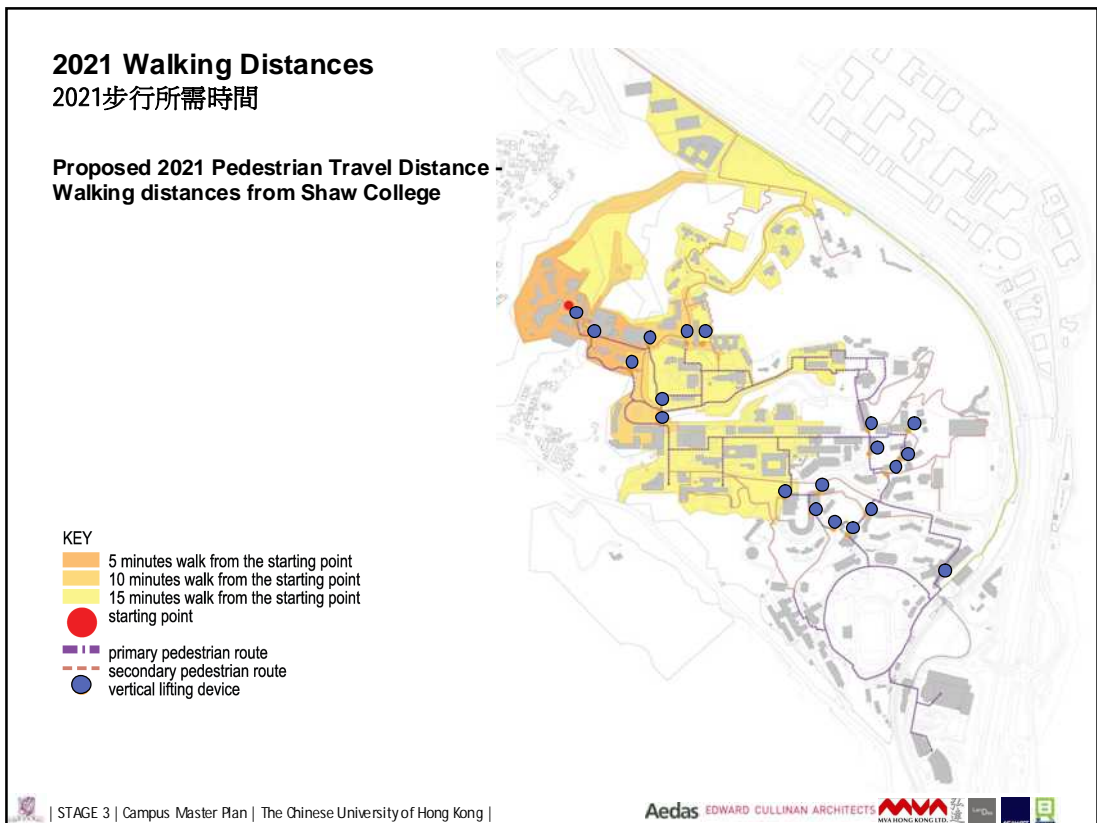
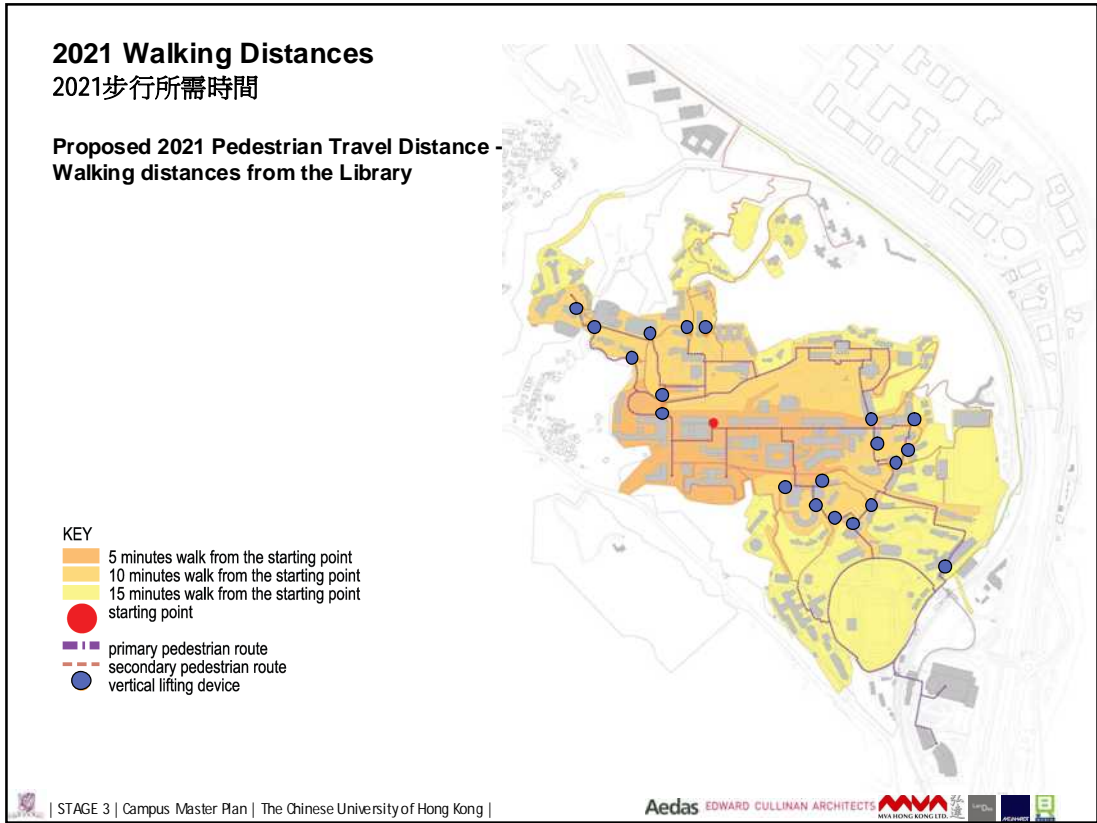

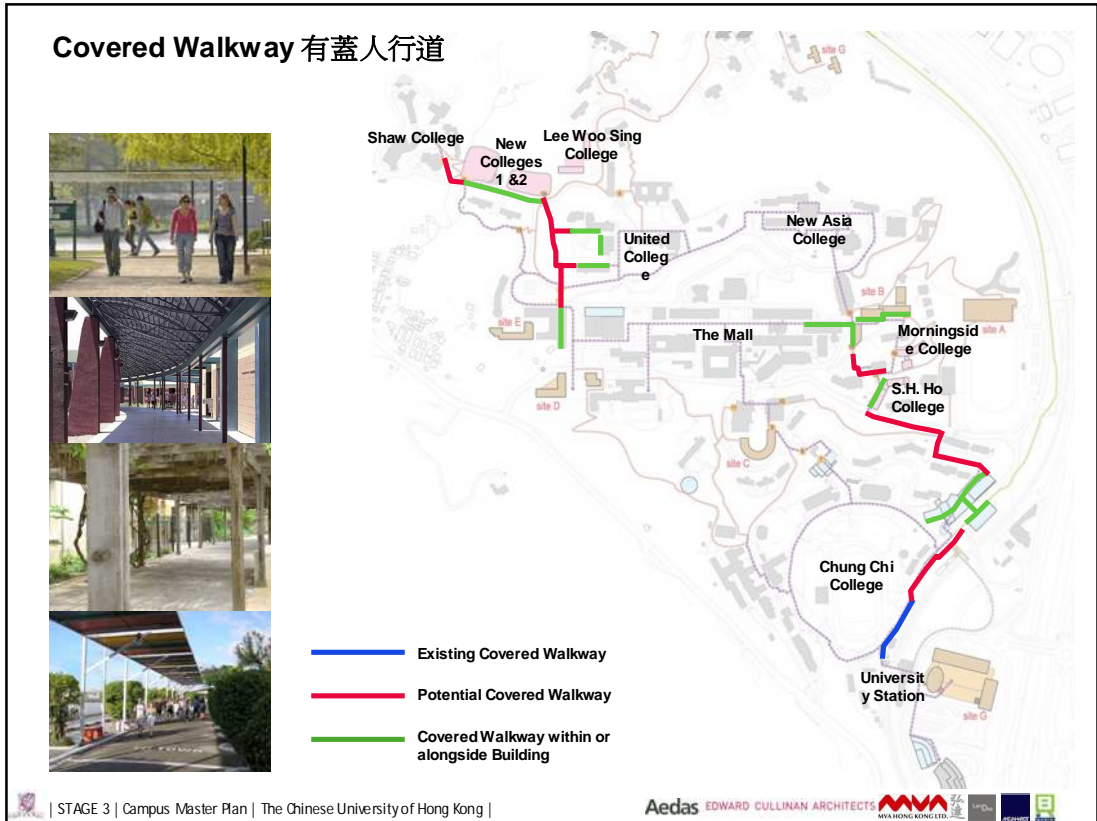

Recommendation for Sustainable Campus 對可持續發展校園的建議

Towards a Low Carbon Campus

Target to be established by CUHK:

- Reduction in energy use per student
- Reduction in annual greenhouse gas (GHG) emission per student



Sustainable Building Design:

Shading

- North-south building orientation
- Deep eaves and balconies
- Vegetation for shading & evaporative cooling
- Covered walkways and colonnades
- Natural daylighting

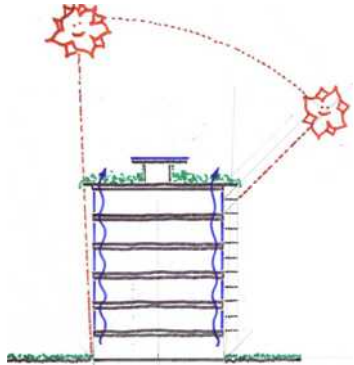

Sustainable Building Design:

Natural Ventilation

- Breezeways, courtyards, colonnades, balconies & atria
- Large openings for cross-ventilation
- High ceilings for good air circulation
- Double skin facades for stack effect cooling
- Shallow floor plates



| STAGE 3 | Campus Master Plan | The Chinese University of Hong Kong |

EDWARD CULLINAN ARCHITECTS MVA HONG KONG LTD. HKS ACQUINT

Sustainable Building Design:

Planted roofs

- For biodiversity
- For rainwater attenuation
- For solar insulation
- To reduce Heat island effect
- For an attractive "5th elevation"



Sustainable Building Design:

Materials

- Lightweight structures
- Night time cooling & insulated thermal mass
- Design for longevity & conserve buildings where possible
- Build using recycled / recyclable materials



| STAGE 3 | Campus Master Plan | The Chinese University of Hong Kong |

EDWARD CULLINAN ARCHITECTS MVA HONG KONG LTD. HKS ACQUINT

